

Customer Fiber Optic Wall Outlet



Application & Product Description

The wall mounted fiber optic enables a fiber optic cable termination point to be presented within the end user home. The wall outlet can accommodate two fiber adaptors, either SC simplex or LC Duplex. Flange or flangeless adaptors can be housed, either recessed or protruding from the faceplate as required. Press fit strain relief features secure the incoming cable whilst cable tie anchor points are provided for additional strain relief. Fiber cables can enter through the base of the unit or through the rear.

Fiber management features ensure a minimum bend radius of 25mm is maintained as the bare fiber is routed through the outlet. Screw holes allow for easy installation and positioning. Alternatively, the recessed base means the unit can be fastened with adhesive or even hot glue, maintaining the outlet flush to the wall.

The wall outlet is made from ABS plastic with a quality design and surface finish. If required can be produced with special plastic components in order to have LSZH and Fire Retardant features.

The cover can be customized with the network operator's logo. Tamper proof latches secure the cover to the base.

The unit can be supplied with adaptors and pigtails if required or even pre-terminated.

Technical Data

Dimensions (mm)	H	W	D
	85	85	16
Number and type of adaptors	2x SC simplex 2x LC Duplex		
Maximum number of splices	2 (up to 45mm)		
Weight (kg)	0,045		
Housing material	ABS ABS LSZH FR (required by customer)		
Colour	RAL 9003 White		
Mechanical IK protection	IK07		
Water&Dust IP protection	IP43		

Features & Benefits

- Maximum capacity 2x SC simplex connectors or 2x LC duplex connectors
- Installed directly on the wall or onto a flush-mount back box
- Cable entry at the base of the unit or through the rear
- Recessed base use with adhesive or hot glue
- Can accommodate up to 2 fusion splice protectors (up to 45mm) or 2 mechanical splices
- Quality surface finish
- Tamper-proof latches
- Customer logo injected at the cover
- Customized full cover with customer design
- Engineered & Produced in EU (Portugal)

Standard Kit Accessories for 1 or 2FO

- 2x Screws
- 2x Bushings
- 1 or 2x Splice sleeves 45mm
- 2x Cable ties
- 1x Laser Sticker

Technical Diagrams

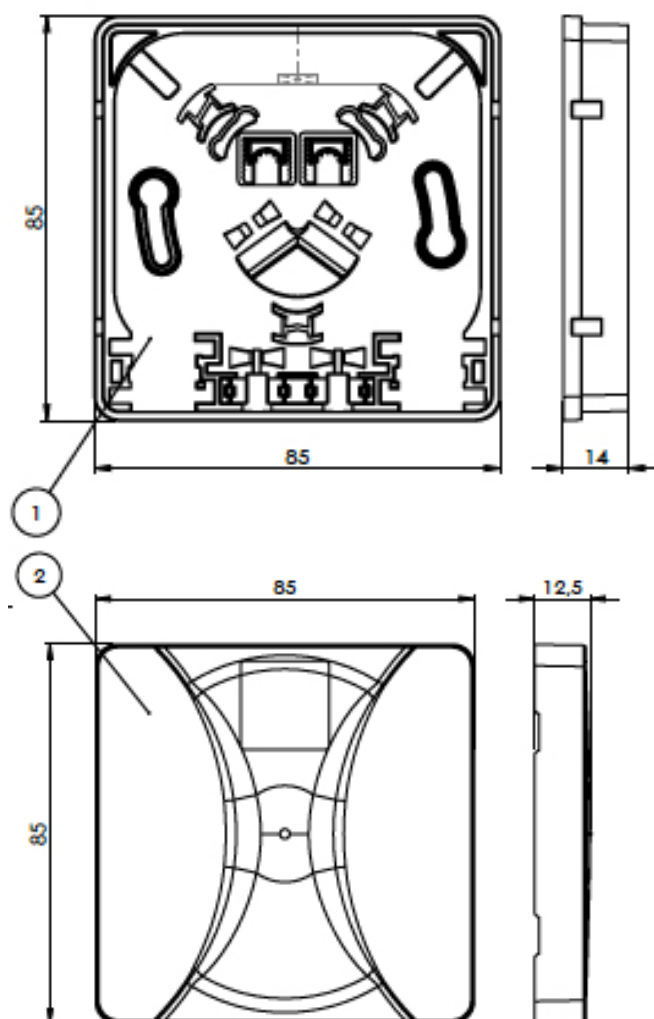

Additional Product Images



TOP View



BOTTOM View



GENERAL View



DETAILED View

End of Technical Data Sheet